



## GENERAL CHARACTERISTICS

Structure	Aluminum
Classification	USCG Subchapter L/T ABS/DNV optional
Flag	USA

## DIMENSIONS

Length O.A.	64 ft (19.5 m)
Length Hull	55.6 ft (16.96m)
Beam O.A.	24 ft (7.30 m)
Depth	8.6 ft (2.70 m)
Draft (max)	4.5 ft (1.36 m)
Displacement (Lightship)	40.4 LT (41 tonnes)

## CAPACITIES

Fuel oil	1585 USG (6,000 L)
Fresh water	103 USG (390 L)
Black water	103 USG (390 L)
Free workdeck area	624 ft <sup>2</sup> (58 m <sup>2</sup> )
Max deck load	0.13 tons/ft <sup>2</sup> (1.25 t/m <sup>2</sup> )
Deck cargo	6 tons fwd, 2 tons aft
Crew	< 3 persons
Passengers	< 12 persons

## PERFORMANCE

Speed (max)	28.0 knots (550 litres/hr)
Speed (high)	24.0 knots (500 litres/hr)
Speed (low)	21.0 knots (430 litres/hr)

## PROPULSION SYSTEM

Main engines	2 x MAN V12-1200
Total power	2 x 882 kW (2 x 1200 hp)
Gearbox	2 x ZF2050
Propulsion	Rolls Royce FF600

## ELECTRICAL EQUIPMENT

Network	24V DC, 208V 60 Hz AC
Generator set	1 x 13.5 kW

## DECK LAY-OUT

Anchor equipment	1 X Fortress FX-125 w/ chain & line
Bow fendering	Manuplas Foam Fender System
Secondary access	Osbit MaXccess / TDD (Tube Docking Device) / VGRIP (optional)
Deck crane	Palfinger PK6500M (optional)
Mob recovery system	Ladder w/ Ship Mounted Davit

## LIFE SAVING EQUIPMENT

USCG Compliant

## ACCOMMODATIONS

Accommodation	12 x Saloon, Galley/Mess Area, 1 x Heads, 2 x Bridge Seats
Noise Levels	<65 dba

# 19M WIND FARM SERVICE VESSEL

Crew Transfer Vessel

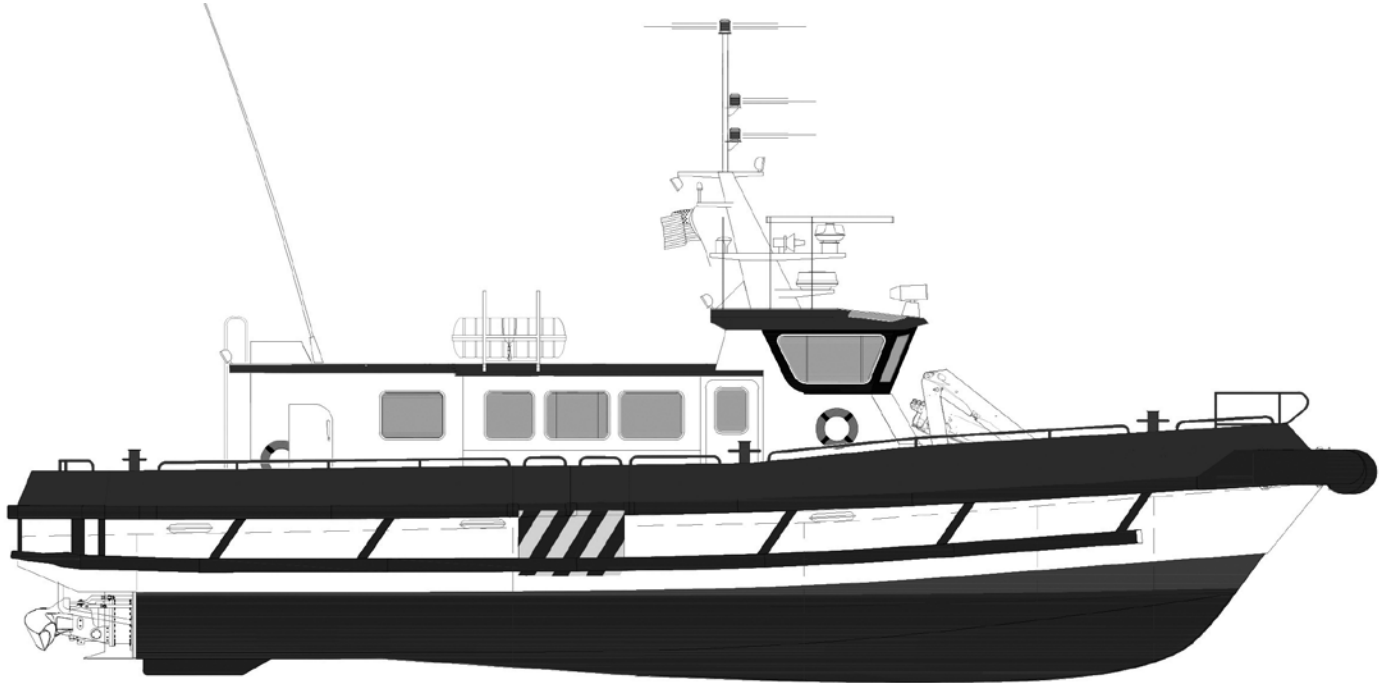

ELEVATION

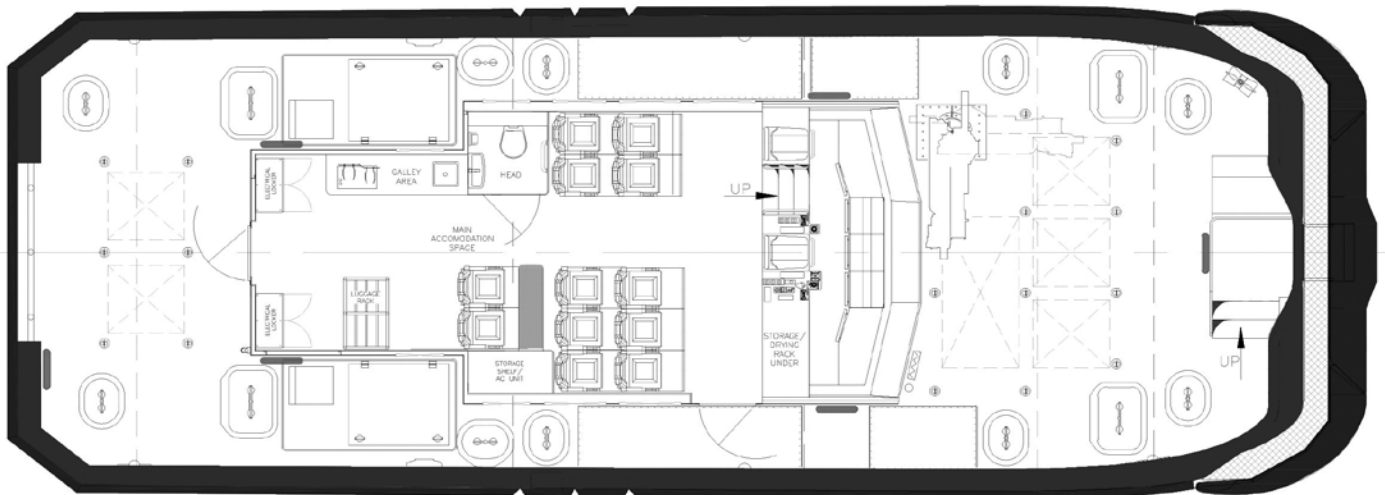

PLAN



Under License with South Boats IOW



461 WATER STREET, PO BOX 368  
WARREN, RHODE ISLAND, 02885

T 401.245.8300 F 401.245.8303 E info@blountboats.com W blountboats.com